

# IS9050, IS9055, IS9070 Finger Guard Safety Seals

Trapping fingers in hinged doors can cause very serious injuries, particularly in locations where young children are present.

The Kilargo finger guard seals provide a deterrent. These seals can assist in providing protection on both sides of the door by using the IS9050 or IS9055 on the hinge knuckle side and the IS9070 on the hinge cavity side (opening / push side) of the door.

*Note: These finger guard seals can assist in reducing the risk of finger pinch injuries on the hinge side of the door, by covering this void with a flexible rubber gasket. Kilargo does not recommend the installation of IS9070 on aluminium door frame systems.*

## Standard lengths

- 2250mm
- Also available in: 250mm increments from 1000mm to 3000mm

## Standard colours

- Silver anodised aluminium with grey PVC cover strip and black gasket
- Black anodised aluminium with black PVC cover strip and black gasket
- Brown, grey and cream colour gaskets available to special order
- IS9055 is only available in black & grey

\*Note: The IS9070 seal when fitted to hinged doors, has a maximum opening limitation of 110 degrees. Kilargo does not recommend the installation of IS9070 on aluminium door frame systems.

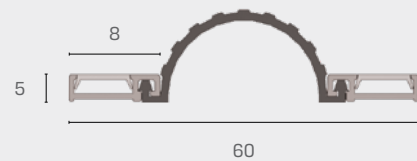

IS9050 Finger Guard Seal - hinge position



IS9055 Finger Guard Seal - hinge position

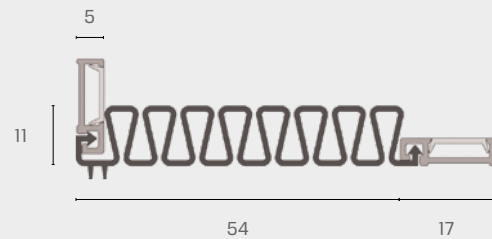

IS9070 Finger Guard Seal

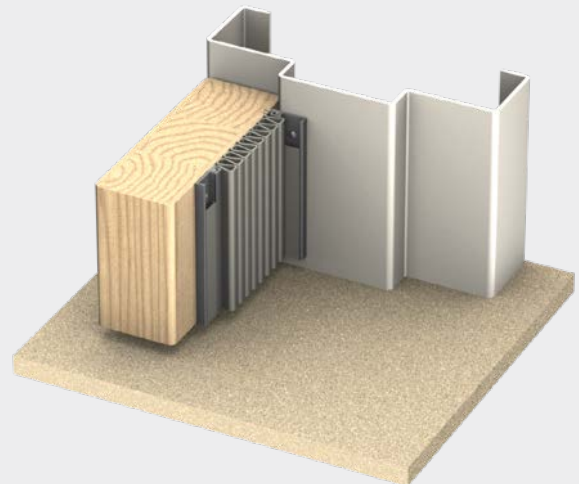
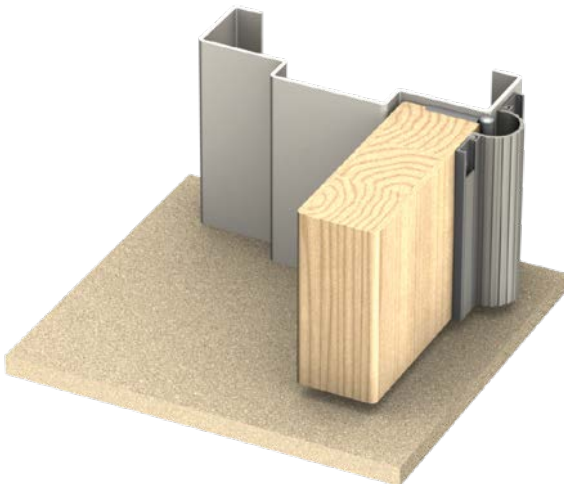

Kilargo IS9050, IS9055, IS9070 Finger Guard Safety Seals | Last edit 10/04/2018

15 Wentworth Pl, Banyo QLD 4014, Australia  
P +61 7 3635 5000 F +61 7 3861 9266 E sales@kilargo.com.au W kilargo.com.au

