



PRIME MINISTER'S  
EXPORT AWARD  
2006, 2012

- ★ THE BEST EXPORTER 2006
- ★ THAI OWNED BRAND 2006
- ★ THAI OWNED DESIGN 2006
- ★ THAI OWNED BRAND 2012



INTERNATIONAL  
ARCH OF EUROPE  
QUALITY AWARD  
2011



IP CHAMPION  
2011



Certificate No. TH03/3040



Certificate No. TH03/3039

### LOCKING OPTIONS:

FRONT

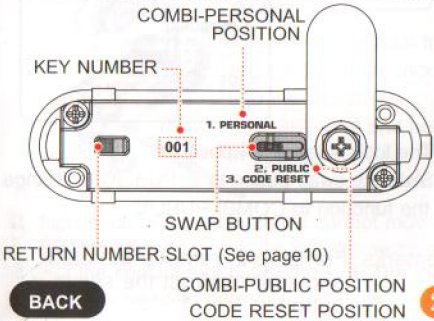
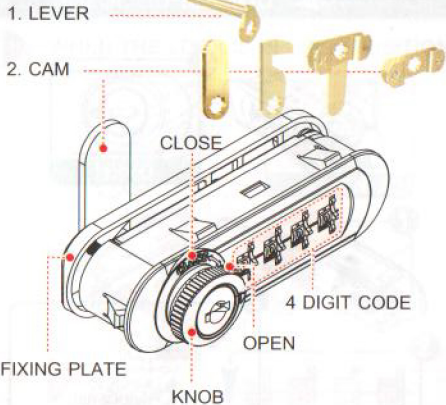

BACK

1

2

### Anti-Bacterial Plastic Key Cap

RECOVERY KEY



K-085-91-CG  
(ANTIBACTERIAL)

INHIBIT BACTERIAL  
GROWTH WITH

99%



R-349-91



### FOR GLASS DOOR CABINET

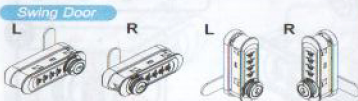

### OPTIONS FIXING PLATE

R-359-91

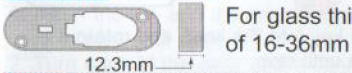

For glass thickness  
of 16-36mm

### Spacer

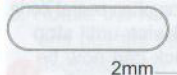

To be used with R-359-91

- 1 piece for thickness of 6 mm
- 2 pieces for thickness of 4mm

R-360-91

3

### FOR METAL CABINET

#### Locker



#### Filing Cabinet

#### Swing Door



### DRILL HOLE

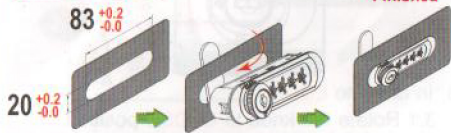

### DRILL HOLE

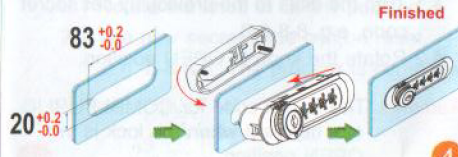

4

## FOR WOODEN CABINET

Swing Door



Tambour Door



Mobile Pedestal

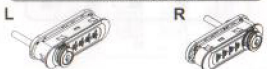

## OPTIONS FIXING PLATE

R-346-91



For wood thickness of 8-12mm

4.6mm

R-359-91

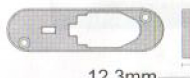

For wood thickness of 16-36mm

12.3mm

R-360-91



For wood thickness of 6mm, use 2 pieces with R-359-91

2mm

## DRILL HOLE

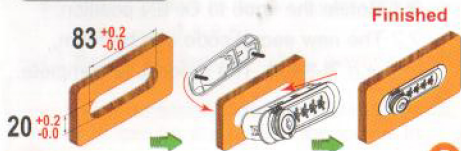

Finished

5

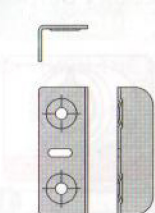

DK-041  
(L-BRACKET)



I-084

FOR WOOD THICKNESS OF 16 - 20mm

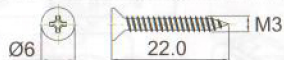

I-089

FOR WOOD THICKNESS OF 20 - 24mm



I-090

FOR WOOD THICKNESS OF 24 - 30mm



I-091

FOR WOOD THICKNESS OF 30 - 36mm

## FOR WOODEN CABINET

6

## OPERATING INSTRUCTIONS COMBI-PERSONAL (No. 821)

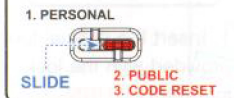
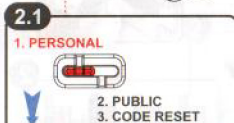
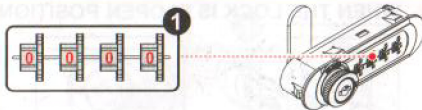

- The preset factory code is 0-0-0-0
- To change the secret code, rotate the knob to **OPEN** position.
  - Slide the swap button to **3. CODE RESET**
  - The new secret code can be reset, e.g. 8-8-8-8

7

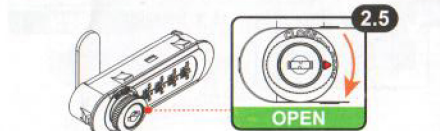
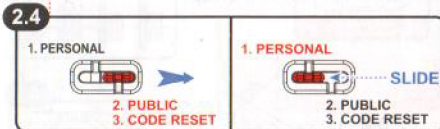
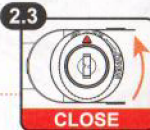
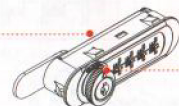

- Rotate the knob to **CLOSE** position.
- Slide the swap button to **1. PERSONAL**
- Rotate the knob back to **OPEN** position to complete the process.

**Remarks:** For Step 2, remove the cam should it obstruct the swap button.

8