

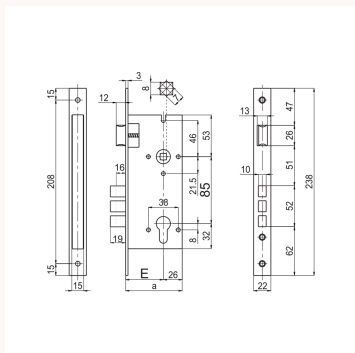





2200 Double Throw Cylinder Deadbolt

2200-45-CP, 2200-45-PB, 2200-45-SC, 2200-50-CP, 2200-50-PB, 2200-50-SC, 2200-60-CP, 2200-60-PB, 2200-60-SC

Three section tamper proof, saw resistant bolt. Note: The 2200 Lock does not have a split follower. Suitable only by operation with handles on both sides or by one handle on one side.



Product type	Doorware
Brand	SAB
Collection	Deadlock
Range	Design
Designers	SAB Design Team
WxDxH	Backset + 24mm x 22mm x 238mm
Colour / Finish	<div style="display: flex; justify-content: space-around; align-items: center;"> <div style="text-align: center;">  <p>Chrome</p> </div> <div style="text-align: center;">  <p>Brass</p> </div> <div style="text-align: center;">  <p>Satin Chrome</p> </div> </div>
Material	Brass
Warranty	5 Year Warranty
Availability	Stocked Item

